

Horizontal Carousel (HOCA)

Visit www.kasten-storage.com/Products/Storage-Machines-and-WMS/Horizontal-Carousel-HOCA/ for the latest information.

Storage machines, automates, are computer-controlled storage and transfer systems that significantly improve the efficiency of product storage and picking. They are easy to integrate with the company's WMS or can be used as standalone systems.

An automatic storage system saves up to 70% on floor space, reduces picking errors by 70% and decreases picking time by more than 60%. The most efficient way of using storage machine is to have article management included with the machine. TC2000 article management software is especially developed for Tornado, Paternoster and HOCA and it can be included as standard to all our machines.

Horizontal Carousel (HOCA) is a product in the category

Storage Machines and WMS

Lift Systems (TORNADO)
PaC-Light
Vertical Carousell (PATERNOSTER)
Horizontal Carousel (HOCA)
WMS and Control Software

Please visit www.kasten-storage.com to see our other products.

Description

Storage Machines and WMS › Horizontal Carousel (HOCA)

Horizontal carousel is an excellent choice for large spaces or low buildings. The horizontal storage system can accommodate large quantities of bulky goods, reducing picking times significantly.

The system brings goods to the operator quickly and ergonomically. Productivity can be boosted even further by connecting several machines to a single retrieval point. This means that the operator can pick from one carousel while other ones are rotating to be ready for next pick.

Carousels can be equipped with pick-to-light systems that make batch-picking very easy and fast for the operator.

References

[Grohe AG, Germany](#)

[Hospital Pharmacy, Germany](#)



Products

Storage Machines and WMS › Horizontal Carousel (HOCA)

- Provides optimal horizontal and vertical utilization.
- Dimensioning allows goods of very dissimilar size to be stored in a single system.
- One operator can use several machines.
- The system offers a safe way to store and handle materials.
- Integration with the warehouse logistics environment and the company's WMS is easy.
- The system offers rapid, easy picking. Picking time can be only 15 seconds / line.
- The HOCA system is user-friendly and safe.
- Batch picking provides great efficiency.
- Restocking is easy to automate.

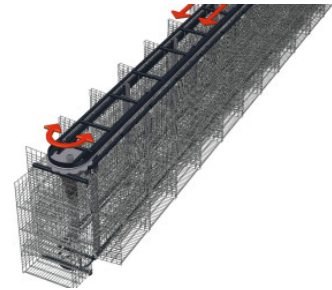
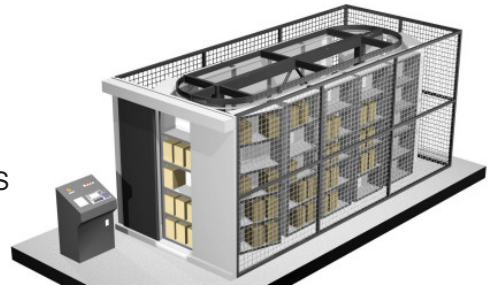

Specifications

Bay width 830 and 1010 mm

Bay depth 508 and 608 mm

Bay height 1700-3900 mm

Tray capacity 100 kg

Shelf division 60 and 120 mm

Bay capacity 600 kg

Total capacity max. 40,000 kg

Total width 1700 and 1900 mm

Total length max. 50 m

Total height 2150-4350 mm

electrical connection 230 VAC, 400 VAC

Motor output 1.5 kW, 2.2 kW

Storage Machines and WMS › Horizontal Carousel (HOCA)

